

JACKSONVILLE STATE UNIVERSITY

Recreation and
Fitness Center

JACKSONVILLE, AL

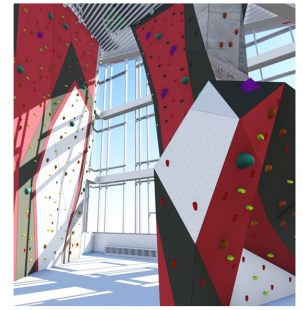

Opened January 2019

“We’re excited about what we think will truly be a game-changing building for our students and our campus. It will establish a new gateway experience for campus visitors and make JSU more competitive for student recruitment and retention. Also, a range of new student development programs will be initiated — specifically designed for student employees, intramural participants, sport club members as well as general student patrons - that will improve the general quality of the JSU experience.”

- **John M. Beehler**, President, Jacksonville State University

In January 2017, the JSU Board of Trustees approved a plan to build a 101,000 SF fitness and wellness center through a public private partnership with the JSU Foundation. As part of that approval, the entire project team was approved including CENTERS as the operator for the new building and all associated programs and services.

Furthermore, in response to a University initiative to enhance the quality of campus life, in July 2017, JSU also retained CENTERS, LLC to take over the management of the university’s existing indoor and outdoor recreational facilities and all associated programming and services. CENTERS operating imperatives during this important pre-opening period include changing the campus culture around engaging in fitness activities, intramurals and sport clubs, implementing a culture of performance among the professional staff, modernize all programs processes and policies, procurement of all new equipment for the new building, create a new student development model for student employees, expand the staff in preparation for the new building and continue to participate in supporting the Foundation’s decision making with respect to the design and construction of the new facility. The new fitness and wellness facility will become the new home base for CENTERS operations and will support a range of wellness and fitness programs and services.

Planning
Brailsford & Dunlavey, Inc.

Operations
CENTERS, LLC

Design Architect
Moody Nolan

Contractor
Turner Construction

\$45M
Project Cost

101,000 SF
Building Size/Program

FACILITY LAYOUT

Main Level

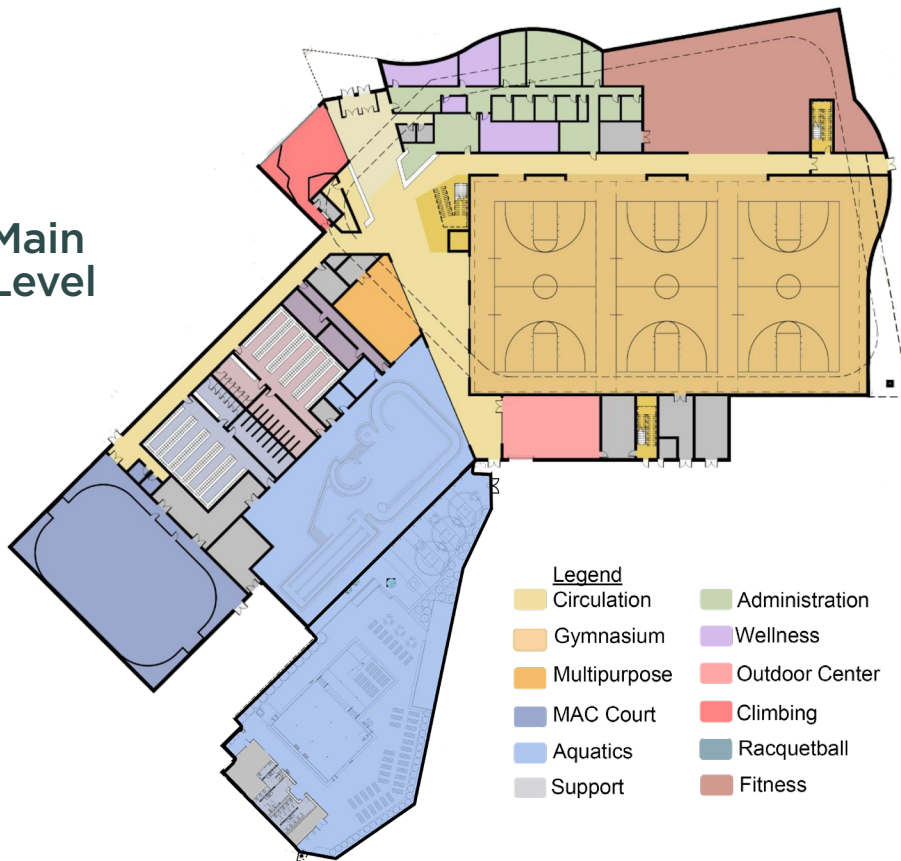

- Legend**
- Circulation
 - Administration
 - Gymnasium
 - Wellness
 - Multipurpose
 - Outdoor Center
 - MAC Court
 - Climbing
 - Aquatics
 - Racquetball
 - Support
 - Fitness

Second Level

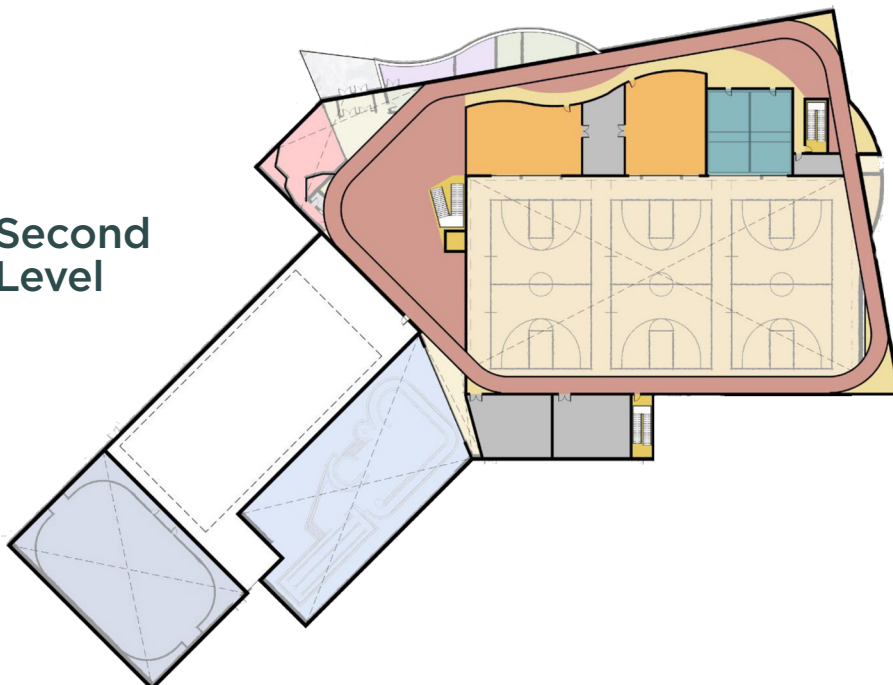

FACILITY FEATURES

- 3-Court Gymnasium
- 3 Group Exercise Studios
- 2 Racquetball Courts
- 10,000 SF of Weight and Fitness
- Over 40 foot Indoor Climbing Wall and Bouldering Wall
- Multipurpose Gymnasium
- Elevated Jogging Track
- Indoor Lap Pool and Outdoor Leisure Pool
- Wet Classroom
- Wellness Center
- Outdoor Adventure Center
- Game Lounge
- Social areas with seating
- Study areas with charging stations
- Juice Bar
- Pro Shop

PARTNER

Jacksonville State University Foundation